

Sport Exhaust System (I-no. 176)

Revision: This bulletin replace bulletin Group 2, #37/10, dated November 12, 2013.
The coding of the sport exhaust system with the PIWIS Tester was changed and updated under Tools.

Model Year: **As of 2010 up to 2013**

Concern: **Retrofitting**

Engine Types: M4820 = 4.8 liter – Panamera S;
M4840 = 4.8 liter – Panamera 4S;
M4870 = 4.8 liter – Panamera Turbo

Note: In the sport exhaust system, the signal for activating the flaps in the rear mufflers comes from the respective current map in the DME control unit. This depends on the driving status and the accelerator pedal position among other things.

The sport exhaust system can be activated using a new switch console with the additional "Twin tailpipe" button (close to the center console).

The regulating time after pressing the button, determined by the response time of the pneumatics, is approx. 2 - 3 seconds. The sport exhaust system is active if the diode in the "Twin tailpipe" button lights up.

Engine power and exhaust behaviour of the vehicle are not affected. The sport exhaust system is also available as a factory installed option for new vehicles by requesting optional equipment "176".



Figure 1

2

Panamera (970)
2601 ENU 37/10

Installation and Conversion Instructions

Parts Info: **970.044.200.12** ⇒ Sport exhaust system, Panamera S/4S – USA, set
970.044.200.15 ⇒ Sport exhaust system, Panamera Turbo, set

Also order the following in accordance with vehicle equipment:

970.613.XXX.XX.FFF¹ ⇒ Button module with “sport exhaust system” (switch console)

¹ See Porsche Electronic Parts Catalog – PET, illustration 903–05

Parts List:

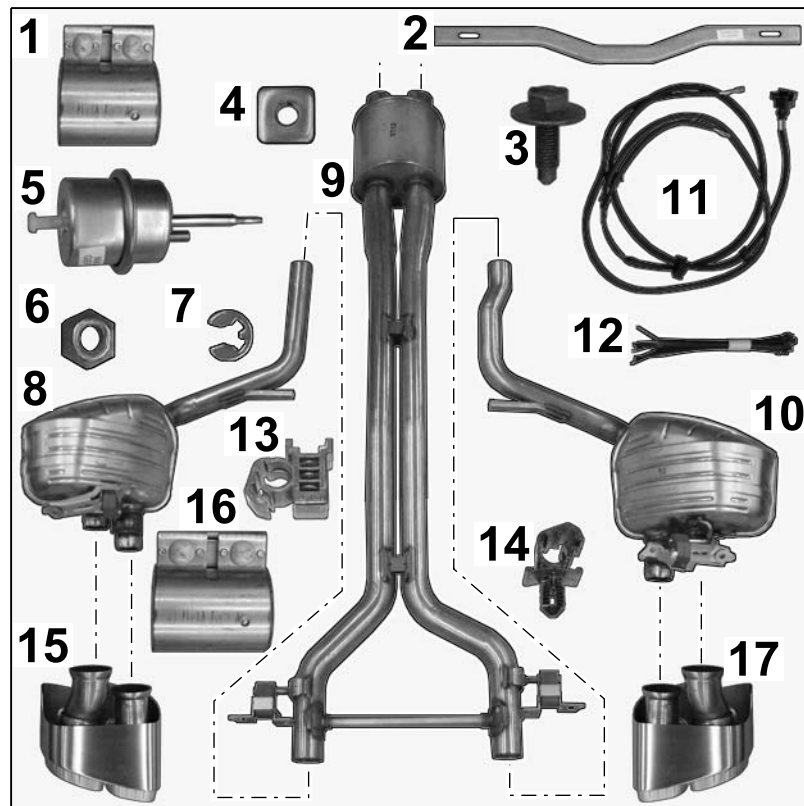

Figure 2

958.111.220.00 ²	2 x	Clamping sleeve, Ø 60 mm, 88 mm long (M4820/40) ⇒ Figure 2-1-
958.111.220.10 ³	2 x	Clamping sleeve, Ø 65 mm, 88 mm long (M4870, not shown)
970.111.221.01	1 x	Transverse strut for rear silencer ⇒ Figure 2-2-
N 908.797.02	2 x	Hexagon-head bolt, M8 x 25 (transverse strut) ⇒ Figure 2-3-
970.111.360.00	2 x	Square nut, M8 (transverse strut) ⇒ Figure 2-4-
970.111.509.01 ²	2 x	Rear muffler vacuum unit ⇒ Figure 2-5-
970.111.547.00	4 x	Lock nut, M6 ⇒ Figure 2-6-

970.111.541.00	4 x	Lock washer ⇒ <i>Figure 2-7-</i>
970.111.911.53 ²	1 x	Rear muffler, left (engine type M4820/40) ⇒ <i>Figure 2-8-</i>
970.111.911.92 ³	1 x	Rear muffler, left (M4870, not shown)
970.111.913.54 ²	1 x	Front muffler (M4820/40) ⇒ <i>Figure 2-9-</i>
970.111.913.93 ³	1 x	Front muffler (M4870, not shown)
970.111.912.53 ²	1 x	Rear muffler, right (M4820/40) ⇒ <i>Figure 2-10-</i>
970.111.912.92 ³	1 x	Rear muffler, right (M4870, not shown)
970.044.200.14 ²	1 x	Wire harness for sport exhaust system ⇒ <i>Figure 2-11-</i>
999.513.052.40 ²	7 x	Tie-wrap, 4.8 x 188 mm ⇒ <i>Figure 2-12-</i>
N 906.968.01 ²	2 x	Hose holder, 4.5 – A, 18 mm ⇒ <i>Figure 2-13-</i>
N 906.813.01 ²	1 x	Hose holder, 4.5 – A, 10 mm ⇒ <i>Figure 2-14-</i>
970.111.681.50	1 x	Sports tailpipe, left incl. ball clamp ⇒ <i>Figure 2-15-</i>
955.111.220.12 ²	2 x	Clamping sleeve, Ø 60 mm, 95 mm long (M4820/40) ⇒ <i>Figure 2-16-</i>
955.111.220.21 ³	2 x	Clamping sleeve, Ø 65 mm, 95 mm long (M4870, not shown)
970.111.682.50	1 x	Sports tailpipe, right incl. ball clamp ⇒ <i>Figure 2-17-</i>

² **ONLY** contained in the sets "Sport exhaust system, Panamera S/4S" (997.044.200.12)!

³ **ONLY** contained in the set "Sport exhaust system, Panamera Turbo" (997.044.200.15)!

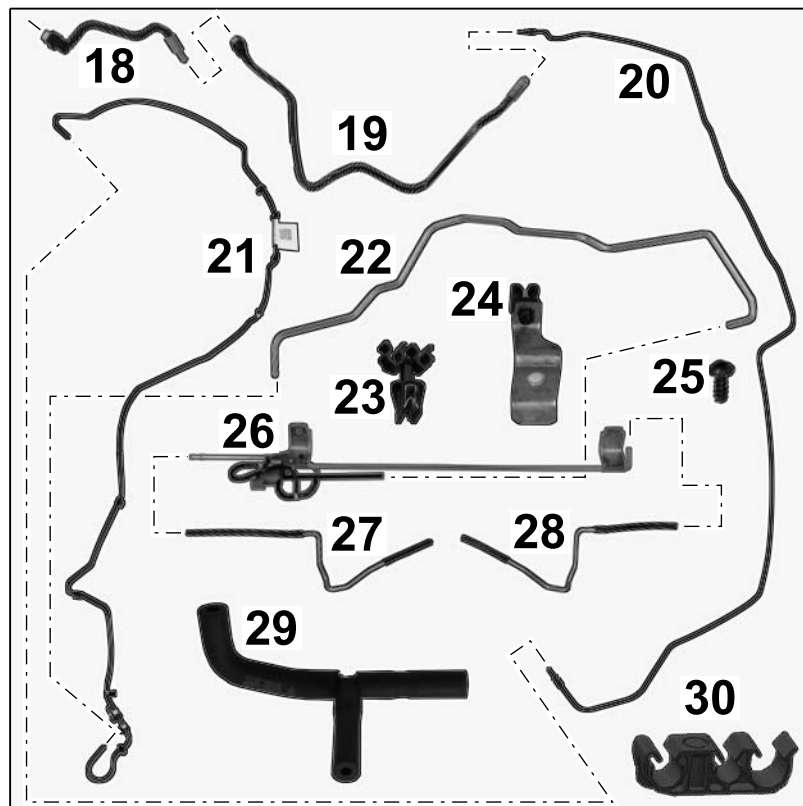

Figure 3

970.110.350.02 ⁴	1 x	Vacuum line (engine compartment) ⇒ Figure 3-18-
970.110.355.01 ⁴	1 x	Vacuum line (wheel housing) ⇒ Figure 3-19-
970.201.361.00 ⁴	1 x	Vacuum line (underbody) ⇒ Figure 3-20-
970.044.200.13 ⁴	1 x	Vacuum line (fuel tank) ⇒ Figure 3-21-
970.111.313.52 ²	1 x	Control line (luggage-compartment pan) ⇒ Figure 3-22-
999.507.176.40 ²	1 x	Combination holder 6.0 (clip, control line in luggage-compartment pan) ⇒ Figure 3-23-
970.111.315.50 ²	1 x	Retaining bracket (control line in luggage-compartment pan) ⇒ Figure 3-24-
N 107.214.01 ²	3 x	Oval-head screw, 6 x 16 ⇒ Figure 3-25-
970.111.312.51 ²	1 x	Change-over valve (assembly) ⇒ Figure 3-26-
970.111.316.51 ²	1 x	Control line, left ⇒ Figure 3-27-
970.111.317.51 ²	1 x	Control line, right ⇒ Figure 3-28-
970.201.433.01	1 x	Carbon canister hose (T-piece, USA ONLY) ⇒ Figure 3-29-
999.651.405.40 ⁴	2 x	Line holder 10/8/12 ⇒ Figure 3-30-

⁴ Moy in USA kit

Materials:	000.043.204.82	1 x	Adhesive/sealing compound, 340 g
	----	1 x	Commercially available rust solvent, e.g. WD40
	----	1 x	Wrapping tape (commercially available)
	----	2 x	Auxiliary line (Tekalan or Teflon hose) approx. 1,500 mm long

Notes: Identifying features when installed

- A** – Rear muffler, left
- B** – Rear muffler, right
- 1** – Marking on rear muffler, left
- 2** – Marking on rear muffler, right
- 3** – Marking on sports tailpipes

The Porsche logo and type number corresponding to vehicle and engine type are shown on the underside of the rear mufflers as follows:

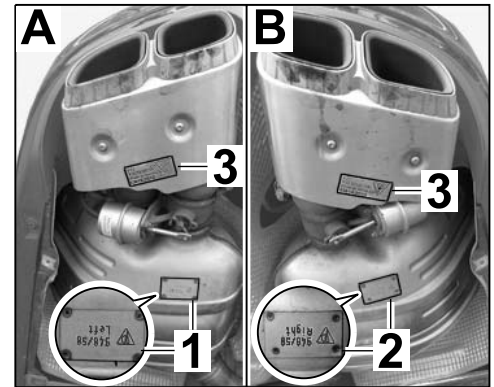

Figure 4

Vehicle/engine type	Rear muffler, left	Rear muffler, right
Panamera S/M4820	948 / 58 Left	948 / 58 Right
Panamera 4S/M4840	948 / 58 Left (⇒ Figure 4 -1-)	948 / 58 Right (⇒ Figure 4 -2-)
Panamera Turbo/M4870	948 / 61 Left	948 / 61 Right

The Porsche logo, part no. and week/year of manufacture are shown on the underside of the sports tailpipes for ALL vehicles and engine types. See example in table below:

	Sport tailpipe, left	Sport tailpipe, right
Part No.	970.111.681.50	970.111.682.50
Week/year of manufacture	Week 18/2010	Week 18/2010

The markings on the rear mufflers can only be read by removing the rear underbody cover. The markings on the sport tailpipes can be read using a mirror, for example.

Tools:	Shop light	Plastic wedge
	9900 - PIWIS Tester 3	

Work Procedure: 1 Preparatory work

- 1.1 Drive the vehicle onto a lifting platform and connect a battery charger (⇒ *Workshop Manual '2X00IN Battery trickle charging*).

1.2 Raise the vehicle (⇒ *Workshop Manual '4X00IN Lifting the vehicle*).

CAUTION

Hot components

- Risk of burns
- ⇒ Let hot components cool down.
- ⇒ Wear personal protective gear.

CAUTION

Heavy components

- Risk of squashing
- ⇒ Wear personal protective gear.
- ⇒ Get someone to help if necessary.

1.3 Remove exhaust system (⇒ *Workshop Manual '260119 Removing and installing exhaust system*).

2 **ONLY** Panamera S (M4820)/Panamera 4S (M4840):
Route vacuum lines for rear mufflers for sport exhaust system

2.1 **ONLY** USA vehicles with "ORVR = Onboard Refueling Vapor Recovery" (I-no. 664):
– Diagram of vacuum removal (carbon canister area)

- 1 – Carbon canister
- 2 – Carbon canister hose (T-piece, supplied)
- 3 – Levelling system pressure accumulator (**ONLY** for vehicles with "Adaptive air suspension" (I-no. 350/351))
- 4 – Sport exhaust system change-over valve (supplied)

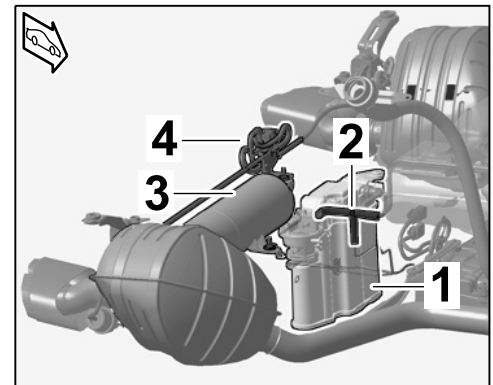

Figure 15

- 2.1.1 Remove standard line between carbon canister and ORVR line (⇒ *Figure 16 -A, arrow-*).
- 2.1.2 Install carbon canister hose (T-piece) between carbon canister and ORVR line (⇒ *Figure 16 -B, arrow-*).

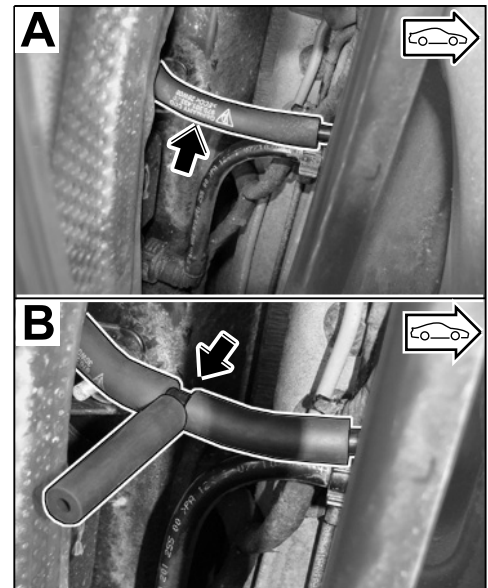

Figure 16

- 2.2 Route and connect control line for luggage-compartment pan
– Diagram of vacuum routing from fuel tank

- A** – Vacuum routing on vehicle **WITHOUT** “Adaptive air suspension” (I-no. 350/351)
- B** – Vacuum routing on vehicle **WITH** “Adaptive air suspension” (I-no. 350/351)
- 1** – Vacuum line for fuel tank
- 2** – Control line (luggage-compartment pan)
- 3** – Change-over valve (assembly)
- 4** – Control line, left
- 5** – Control line, right
- 6** – Levelling system pressure accumulator (**ONLY** for vehicles with “Adaptive air suspension” (I-no. 350/351))

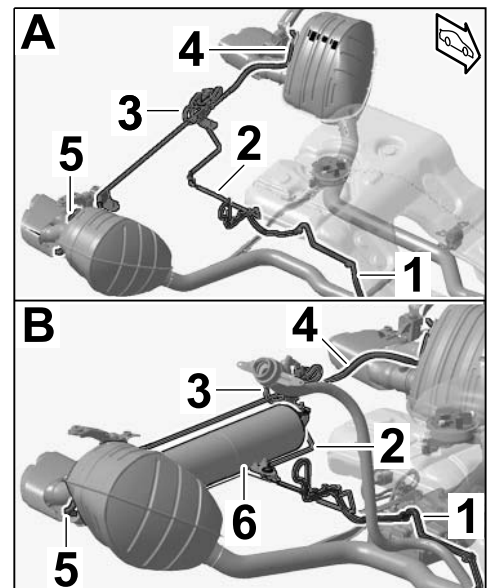

Figure 17

- 2.2.1 **ONLY** for vehicles with "Adaptive air suspension" (I-no. 350/351):
Loosen the levelling system pressure accumulator (⇒ *Workshop Manual '438219 Removing and installing pressure accumulator for levelling system*) and hang it on the components around it.

Do **NOT** open pressure lines!

- A** – Fitting change-over valve, right side
- B** – Fitting change-over valve, left side
- 1** – Levelling system pressure accumulator
- 2** – Change-over valve (assembly)
- 3** – Underside of luggage-compartment pan

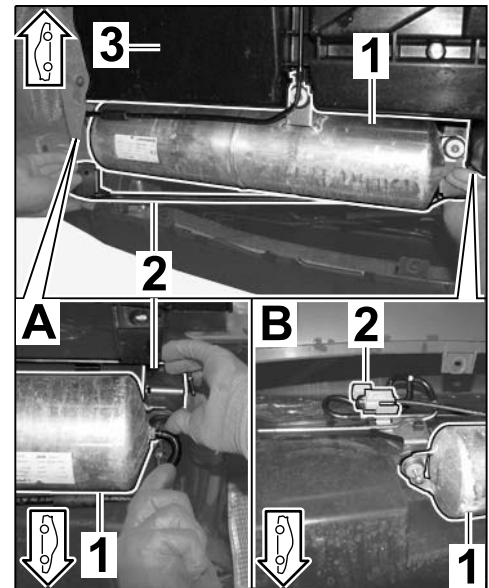

Figure 18

Fit change-over valve (assembly) together with the levelling system pressure accumulator and new oval-head screws (6 x 16, 2 ea.) on the underside of the luggage-compartment pan (⇒ *Figure 18*).

Tightening torque 6 Nm (4.5 ftlb.)

- 2.2.2 Fit combination holder 6.0 (clip, 1 ea.) on the very front strengthening rib (underside of luggage-compartment pan) (⇒ *Figure 19*).

- 1** – Combination holder 6.0 (clip)
- 2** – Underside of luggage-compartment pan
- 3** – Control line in luggage-compartment pan
- 4** – Pressure line for levelling system pressure accumulator (**ONLY** for vehicles with "Adaptive air suspension" (I-no. 350/351))

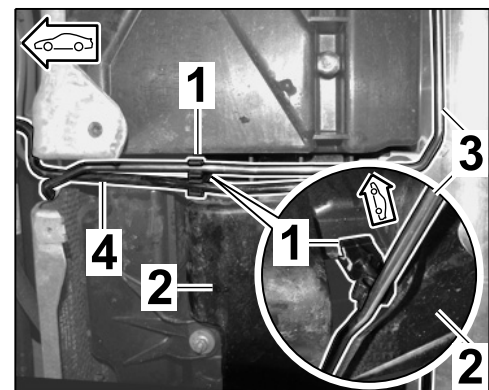

Figure 19

- 2.2.3 **ONLY** for vehicles without “Adaptive air suspension” (I-no. 350/351):
 Fit retaining bracket (control line in luggage-compartment pan) with an oval-head screw (6 x 16, 1 ea.) on the underside of the luggage-compartment pan.
Tightening torque 6 Nm (4.5 ftlb.)

- 1 – Oval-head screw, 6 x 16
- 2 – Retaining bracket
- 3 – Routing of control line in luggage-compartment pan

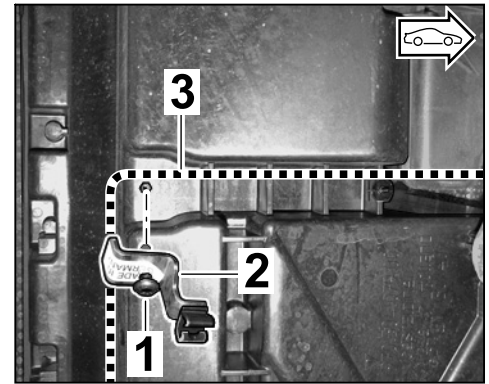

Figure 20

- 2.2.4 Fit change-over valve (assembly) with oval-head screws (6 x 16, 2 ea.) on the underside of the luggage-compartment pan.

Tightening torque 6 Nm (4.5 ftlb.)

- 2.2.5 Insert control line at least 10 mm into the change-over valve hose and clips (3 ea.) (⇒ Figure 21)

- 1 – Control line (luggage-compartment pan)
- 2 – Change-over valve hose
- A – Retaining bracket for control line (**ONLY** for vehicles without “Adaptive air suspension” (I-no. 350/351))

arrows – Clip

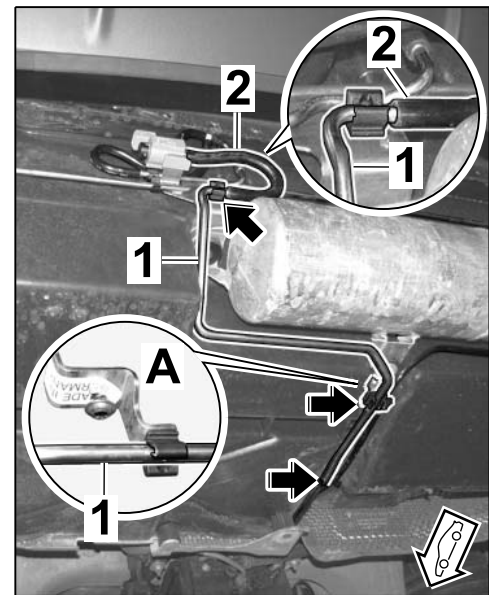

Figure 21

- 2.2.6 **Only** Panamera S (M4820)/Panamera 4S (M4840), USA vehicles with "ORVR = Onboard Refueling Vapor Recovery" (I-no. 664):
Insert control line (luggage-compartment pan) at least 10 mm into the carbon canister hose (T-piece) (⇒ *Figure 22*).

- 1 – Control line (luggage-compartment pan)
- 2 – Carbon canister hose (T-piece)

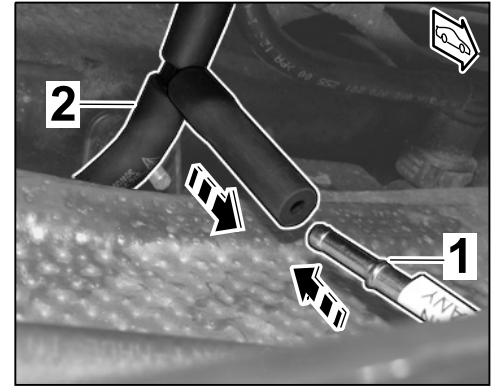

Figure 22

- 2.2.7 Insert control line (luggage-compartment pan) at least 10 mm into the vacuum line for the fuel tank.
Fit pre-assembled line holders (4 ea.) on control line.

- 1 – Control line (luggage-compartment pan)
- 2 – Vacuum line for fuel tank
- 3 – Line holder (pre-assembled)

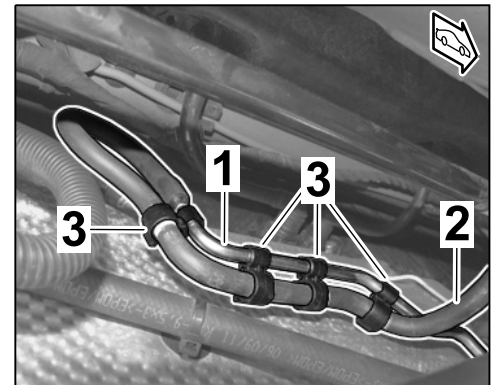

Figure 23

- 3 Route and connect wire harness for sport exhaust system

- 3.1 Preparatory work (wire harness for sport exhaust system)

- 3.1.1 Remove left luggage compartment trim panel (luggage compartment cover) at the side (⇒ *Workshop Manual '70061901 Removing and installing luggage compartment trim panel (luggage compartment cover) at the sides*).

3.1.2 Open the cable duct, loosen the fuse box (⇒ *Workshop Manual '978409 Loosening and securing fuse box'*) and remove control unit for rear-end electronics (⇒ *Workshop Manual '578919 Removing and installing control unit for rear-end electronics'*, ⇒ *Figure 24*).

- 1 – Fuse box
- 2 – Control unit for rear-end electronics

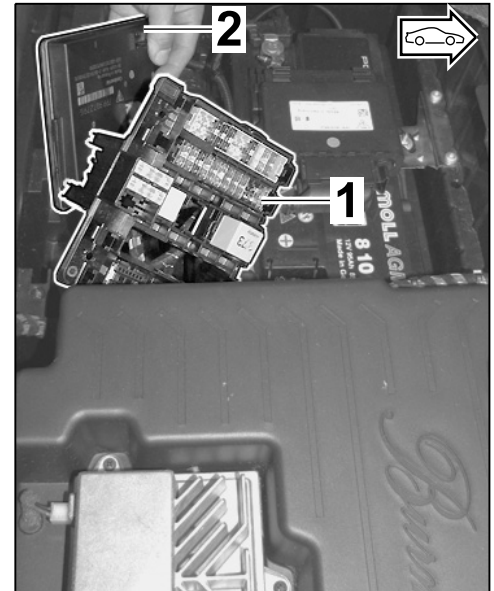

Figure 24

3.1.3 Release and remove socket strip (grey) in the connector housing (blue, 42-pin, control unit for rear-end electronics) (⇒ *Figure 25*).

- 1 – Connector housing (blue, 42-pin, control unit of rear-end electronics)
- 2 – Socket strip (grey)

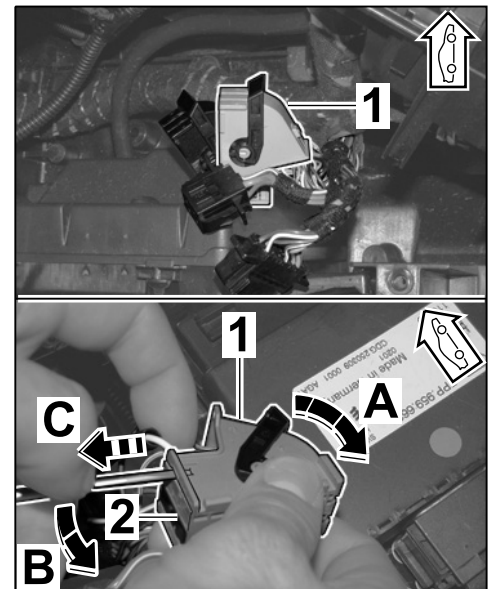

Figure 25

3.2 Route electric wire harness for sport exhaust system

- 1 – Rubber sleeve
- 2 – Wire harness for ParkAssist
- 3 – Wire harness for sport exhaust system

3.2.1 Remove rubber sleeve on wire harness for ParkAssist (rear end plate, left) and carefully punch the lower area at the center.

3.2.2 Guide line 1.0² BK/BN with cable shoe A6 and line 1.0² WH with socket contact (wire harness for sport exhaust system, ⇒ *Figure 26-3-*) through the rubber sleeve into the luggage compartment (⇒ *Figure 26*).

3.2.3 Guide 2-pin connector (wire harness for sport exhaust system) along wire harness for ParkAssist to the electric change-over valve.

- 1 – Connector, 2-pin
- 2 – Wire harness for sport exhaust system
- 3 – Wire harness for ParkAssist
- 4 – Electric change-over valve
- 5 – Hose holder, 4.5 – A, 10 mm
- 6 – Hose holder, 4.5 – A, 18 mm
- 7 – Hose holder, 4.5 – A, 18 mm
- 8 – Tie-wrap, 4.8 x 188 mm

3.2.4 Fit hose holder 4.5 – A, 10 mm (⇒ *Figure 27-5-*) and hose holder 4.5 – A, 18 mm (⇒ *Figure 27-6-*) on the threaded bolts on the rear end panel.

Fit second hose holder 4.5 – A, 18 mm (⇒ *Figure 27-7-*) on the rear apron retaining frame.

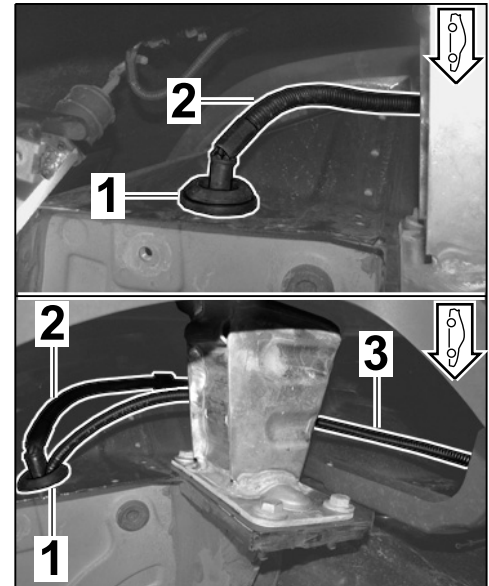

Figure 26

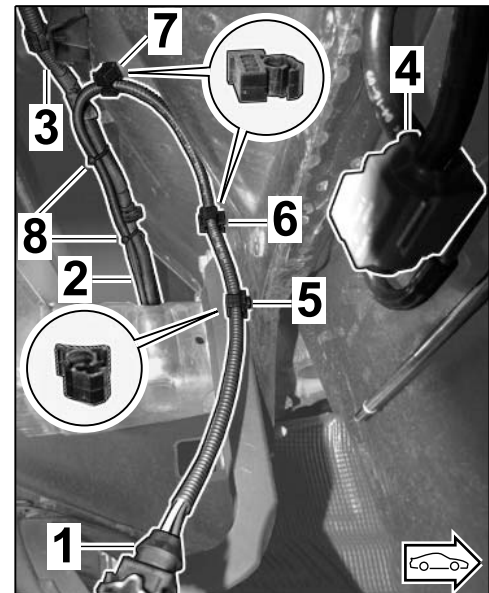

Figure 27

- 3.2.5 Connect 2-pin plug connection (wire harness for sport exhaust system/electric change-over valve).
- 3.2.6 Position and secure wire harness for sport exhaust system in the hose holders (⇒ *Figure 27-5 to 7-*).
- 3.2.7 Secure wire harness for sports exhaust system to wire harness for ParkAssist without tensile strength and so that no chafing occurs using tie-wraps (4.8 x 188 mm, 3 ea., ⇒ *Figure 27-8-*).

Slide remaining length of wire harness for sport exhaust system through the rubber sleeve (⇒ *Figure 28-4-*) into the luggage compartment.

- 3.2.8 Route line 1.0² WH with socket contact (wire harness for sport exhaust system) to the socket strip (grey).

- 1** – Line 1.0² WH with socket contact
- 2** – Line 1.0² BK/BN with cable shoe A6
- 3** – Ground pin 27 (M6)
- 4** – Rubber sleeve in rear end panel

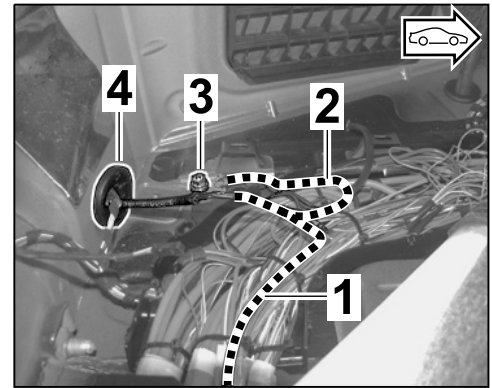

Figure 28

Route line 1.0² BK/BN with cable shoe A6 (wire harness for sport exhaust system) in the luggage compartment to ground pin 27 (M6).

- 3.2.9 Seal rubber sleeve (rear end plate, ⇒ *Figure 28-4-*) from inside and outside with adhesive/sealing compound.

- 3.3 Connect wire harness for sports exhaust system

- 1** – Line 1.0² WH
 - 2** – Socket strip (grey)
 - 3** – Connector housing (blue, 42-pin)
- Socket contact; line 1.0² WH → socket strip (grey), chamber 2
 - Cable shoe A6; line 1.0² BK/BN → ground pin 27 (M6)

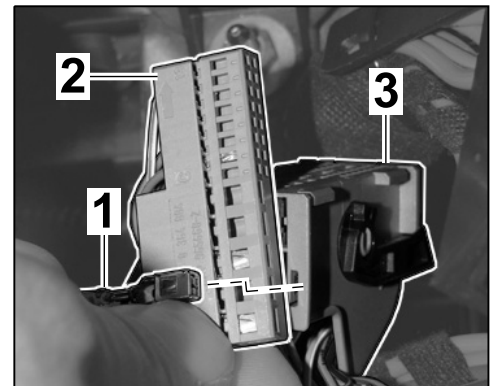

Figure 29

Fit and lock socket strip (grey) in the connector housing (blue, 42-pin, control unit for rear-end electronics).

- 3.4 Concluding work (wire harness for sport exhaust system)

- 3.4.1 Install control unit for rear-end electronics (⇒ *Workshop Manual '578919 Removing and installing control unit for rear-end electronics*).
 - 3.4.2 Secure the rear fuse box (⇒ *Workshop Manual '978409 Loosening and securing fuse box*)
 - 3.4.3 Secure remaining length of wire harness for sport exhaust system to existing lines without tensile strength and so that no chafing occurs using tie-wraps and close the cable duct.
 - 3.4.4 Install left luggage compartment trim panel (luggage compartment cover) at the side (⇒ *Workshop Manual '70061901 Removing and installing luggage compartment trim panel (luggage compartment cover) at the sides*).
 - 3.4.5 Install heat shield on rear silencer at the left/right.
- 4 Convert front button module
- 1 – Switch console, front
 - 2 – Button module with “sport exhaust system”
- 4.1 Remove front switch console (⇒ *Workshop Manual '962719 Removing and installing switch console*)

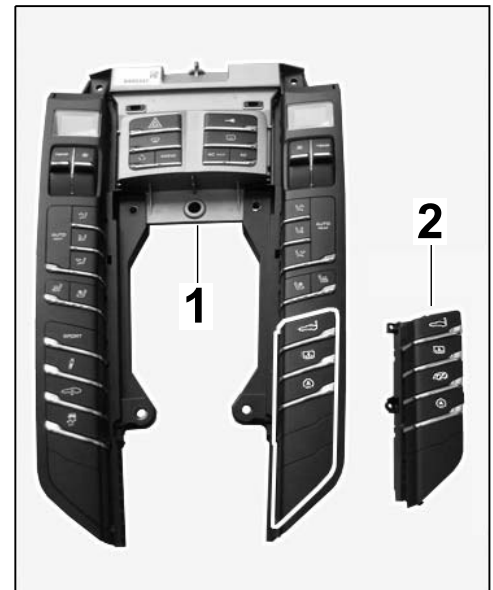

Figure 30

4.2 Replace button module (bottom right).

- 1 – Switch console, front
- 2 – Button module with “sports exhaust system”
- 3 – Connector
- arrows** – Screw, 2.5 x 12 (self-tapping)

4.2.1 Disconnect plug connection.

4.2.2 Remove screw (2.5 x 12, self-tapping, 5 ea.).

4.2.3 Replace button module with new button module with “sport exhaust system”.

4.2.4 Fit screw (2.5 x 12, self-tapping, 5 ea.).

Tightening torque 0.5 Nm (0.5 ftlb.) +/-0.05 Nm (+/-0.05 ftlb.)

4.2.5 Connect plug connection.

4.3 Install front switch console (=> *Workshop Manual '962719 Removing and installing switch console*).

5 Install new sport exhaust system.

5.1 Install new front muffler with a new clamping sleeve –95 mm long– (2 ea.) (see also => *Workshop Manual '260119 Removing and installing exhaust system*).

Tightening torque 23 Nm (17 ftlb.) +/-2 Nm (+/-1.5 ftlb.)

5.2 Install new rear muffler (see also => *Workshop Manual '263319 Removing and installing rear silencer*).

- L** – Rear muffler, left
- R** – Rear muffler, right
- 1** – Clamps for control line
- 2** – Control line, left
- 3** – Control line, right

5.2.1 Position left control line/right control line on the relevant rear muffler and fit into the clamps (=> *Figure 32-1*).

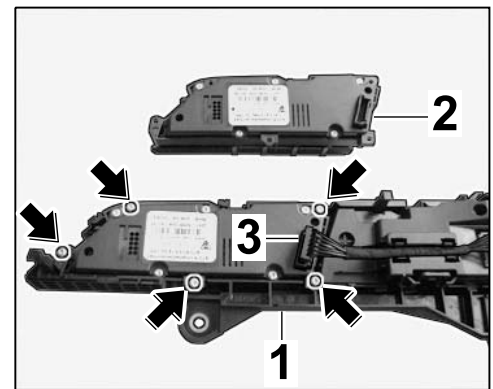

Figure 31

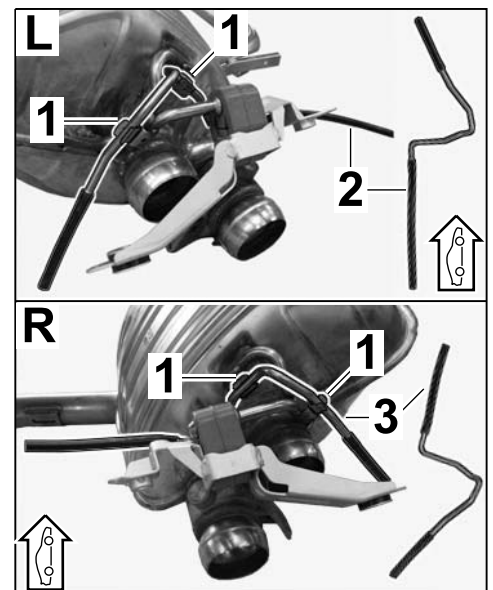

Figure 32

- 5.2.2 Fit left/right rear muffler with a new clamping sleeve –88 mm long– (2 ea.) on the front muffler.

Tightening torque 33 Nm (24 ftlb.) +/-5 Nm (+/-3.5 ftlb.)

- 1 – Front muffler
2 – Clamping sleeve –88 mm long–
3 – Transverse strut

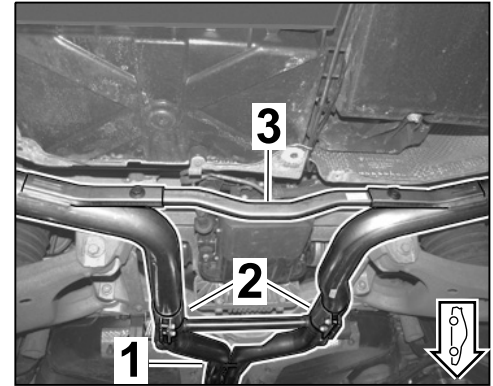

Figure 33

- 5.2.3 Install new transverse strut with a new hexagon-head bolt (M8 x 25, 2 ea.) and square nut (M8, 2 ea.) between the left and right rear muffler (elbow facing down) (⇒ Figure 33).

Tightening torque 23 Nm (17 ftlb.) +/-3 Nm (+/-2 ftlb.)

- 5.3 Install new sport tailpipe at the left/right and align with the rear apron (⇒ *Workshop Manual '263419 Removing and installing tailpipe*).

Tightening torque 30 Nm (22 ftlb.)

- 5.4 Convert and install rear muffler vacuum unit (2 ea.) on the left/right rear muffler for the sport exhaust system.

- L – Rear muffler, left
R – Rear muffler, right
1 – Rear muffler vacuum unit
2 – Lock nut, M6
3 – Lock washer

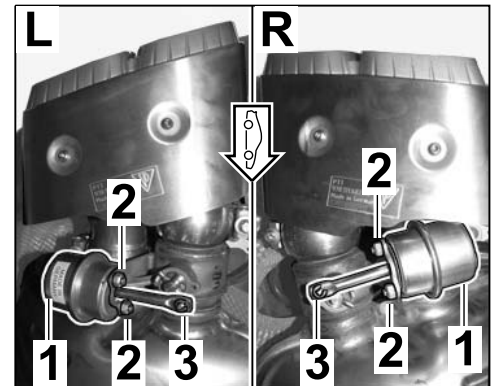

Figure 34

- 5.4.1 **ONLY** for Panamera Turbo (M4870):

Remove rear muffler vacuum unit from the old rear muffler and fit on the left/right rear muffler for the sport exhaust system with new lock nuts (M6, 2 ea.) and a new lock washer (1 ea.).

- 5.4.2 **ONLY** for Panamera S (M4820)/Panamera 4S (M4840):

Fit new rear muffler vacuum unit on the left/right rear muffler for the sport exhaust system with new lock nuts (M6, 2 ea.) and a new lock washer (1 ea.).

- 5.4.3 Fit rubber line for control lines at least 10 mm onto the connection for each rear muffler vacuum unit.

- 5.4.4 Tighten lock nut on rear muffler vacuum unit (2 ea.).

Tightening torque 8 Nm (6 ftlb.) +/-1.2 Nm (+/-1 ftlb.)

- 5.5 Concluding work (sport exhaust system)

- 5.5.1 Install –center– underbody panelling (⇒ *Workshop Manual '519319 Removing and installing cover for centre underbody*).
- 5.5.2 Install –rear– underbody panelling (⇒ *Workshop Manual '519419 Removing and installing cover for rear underbody*).



Information

The **9900 - PIWIS Tester III** instructions take precedence since the description may be different with later Tester releases.

The procedure described here has been structured in general terms; different text or additions may appear on the **9900 - PIWIS Tester III**.

- 6 Code sports exhaust system and perform function test.
 - 6.1 **9900 - PIWIS Tester 3** must be connected before switching on the ignition.
 - 6.2 Select vehicle type "Panamera". Press •F12" to continue.
 - 6.3 Code new button module and enter the sport exhaust system in the vehicle data.
 - 6.3.1 Switch to the control unit overview by touching the "Overview" cell. Press the •F7" to switch to the "Additional menu" item.
 - 6.3.2 Select the "Management of vehicle order" function. Press •F12" until "M numbers" appears in the Value group column.
 - 6.3.3 Select "SPORT EXHAUST SYSTEM" in the Coding value column and tick the "Installed" column. Press •F8" to continue.
 - 6.3.4 Wait until the message "Modified values have been buffered" is displayed and a tick appears next to "176 – SPORT EXHAUST SYSTEM". Press •F12" several times to confirm the changes and then press •F8" to write the changes.
 - 6.3.5 Wait until the message "Creation of vehicle order has been completed." appears. Continue to Log management by pressing •F12" .
 - 6.3.6 Open the log by pressing •F10" and check that vehicle equipment "Sport exhaust system" has been entered, then close the log.
 - 6.3.7 Press •F11" to switch to the control unit overview.
 - 6.4 Code the sport exhaust system.
 - 6.4.1 Select all control units (•CTRL+A"). Press •F12" to continue.
 - 6.4.2 Switch to the "Automatic coding" of control units mode in the "Codings/adaptations" menu. Press •F12" to continue.
 - 6.4.3 Once coding is completed successfully, a tick will appear in the "Status" column.
 - 6.5 Perform "Sport exhaust system" function test

- 6.5.1 Start the engine and select "Rear-end electronics" in the Control unit overview menu. Then switch to the "Drive links/checks" menu.
- 6.5.2 Select the "Actuators" function. Press •F12" to continue.
- 6.5.3 Select "Exhaust flap activation" in the Drive links/checks column and start the function by pressing •F12" .
"Function is running" will appear as the status.

Check that the tappets on the rear silencer vacuum units extend and retract correctly if necessary.

- 6.6 Once coding is complete, read out the fault memories of all systems, correct any existing faults and erase the fault memory (⇒ *Workshop Manual '0X03IN Maintenance diagnosis: Diagnosis system and maintenance inter...*).
- 6.7 Switch off ignition and disconnect **9900 - PIWIS Tester 3**.
- 6.8 Disconnect battery charger (⇒ *Workshop Manual '2X00IN Battery trickle charging*).

26 01 31 03: **ONLY** for Panamera S (M4820)/Panamera 4S (M4840)/USA vehicles:

–Sport exhaust system (1 x) retrofitted–

Labor time: **520 TU**

Includes: Standard front and rear mufflers converted
Routing and connecting vacuum lines from carbon canister to change-over valve
Routing and connecting wire harness for sport exhaust system
Converting and coding button module
Coding sport exhaust system and performing function test
Reading out fault memory and correcting and erasing faults.

26 01 31 06: **ONLY** for Panamera Turbo (M4870):

–Sport exhaust system (1 x) retrofitted–

Labor time: **310 TU**

Includes: Standard front and rear mufflers converted
Converting rear muffler vacuum units and connecting vacuum lines
Converting and coding button module
Coding sport exhaust system and performing function test

Reading out fault memory and correcting and erasing faults.

Important Notice: Technical Bulletins issued by Porsche Cars North America, Inc. are intended only for use by professional automotive technicians who have attended Porsche service training courses. They are written to inform those technicians of conditions that may occur on some Porsche vehicles, or to provide information that could assist in the proper servicing of a vehicle. Porsche special tools may be necessary in order to perform certain operations identified in these bulletins. Use of tools and procedures other than those Porsche recommends in these bulletins may be detrimental to the safe operation of your vehicle, and may endanger the people working on it. Properly trained Porsche technicians have the equipment, tools, safety instructions, and know-how to do the job properly and safely. If a particular condition is described, do not assume that the bulletin applies to your vehicle, or that your vehicle will have that condition. See your authorized Porsche Dealer for the latest information about whether a particular technical bulletin applies to your vehicle. Part numbers listed in these bulletins are for reference only. Always check with your authorized Porsche dealer to verify the current and correct part numbers. The work procedures updated electronically in the Porsche PIWIS diagnostic and testing device take precedence and, in the event of a discrepancy, the work procedures in the PIWIS Tester are the ones that must be followed.

© Porsche Cars North America, Inc.

Dealership	Service Manager	_____	Shop Foreman	_____	Service Technician	_____	_____	_____	_____
Distribution									
Routing	Asst. Manager	_____	Warranty Admin.	_____	Service Technician	_____	_____	_____	_____

Dr. Ing. h.c. F. Porsche AG is the owner of numerous trademarks, both registered and unregistered, including without limitation the Porsche Crest®, Porsche®, Boxster®, Carrera®, Cayenne®, Cayman®, Macan®, Panamera®, Speedster®, Spyder®, Tiptronic®, VarioCam®, PCM®, PDK®, 911®, RS®, 4S®, 718®, 918 Spyder®, FOUR UNCOMPROMISED®, and the model numbers and distinctive shapes of the Porsche automobiles such as, the federally registered 911 and Boxster automobiles. The third party trademarks contained herein are the properties of their respective owners. Porsche Cars North America, Inc. believes the specifications to be correct at the time of printing. However, specifications, standard equipment and options are subject to change without notice. Some options may be unavailable when a car is built. Some vehicles may be shown with non-U.S. equipment. Please ask your authorized Porsche dealer for advice concerning the current availability of options and verify the optional equipment that you ordered. Porsche recommends seat belt usage and observance of traffic laws at all times.

Printed in the USA